

# 4" TC X 3/4" TC REDUCER

**CONFIDENTIAL**  
Property of  
Eagle Stainless Container

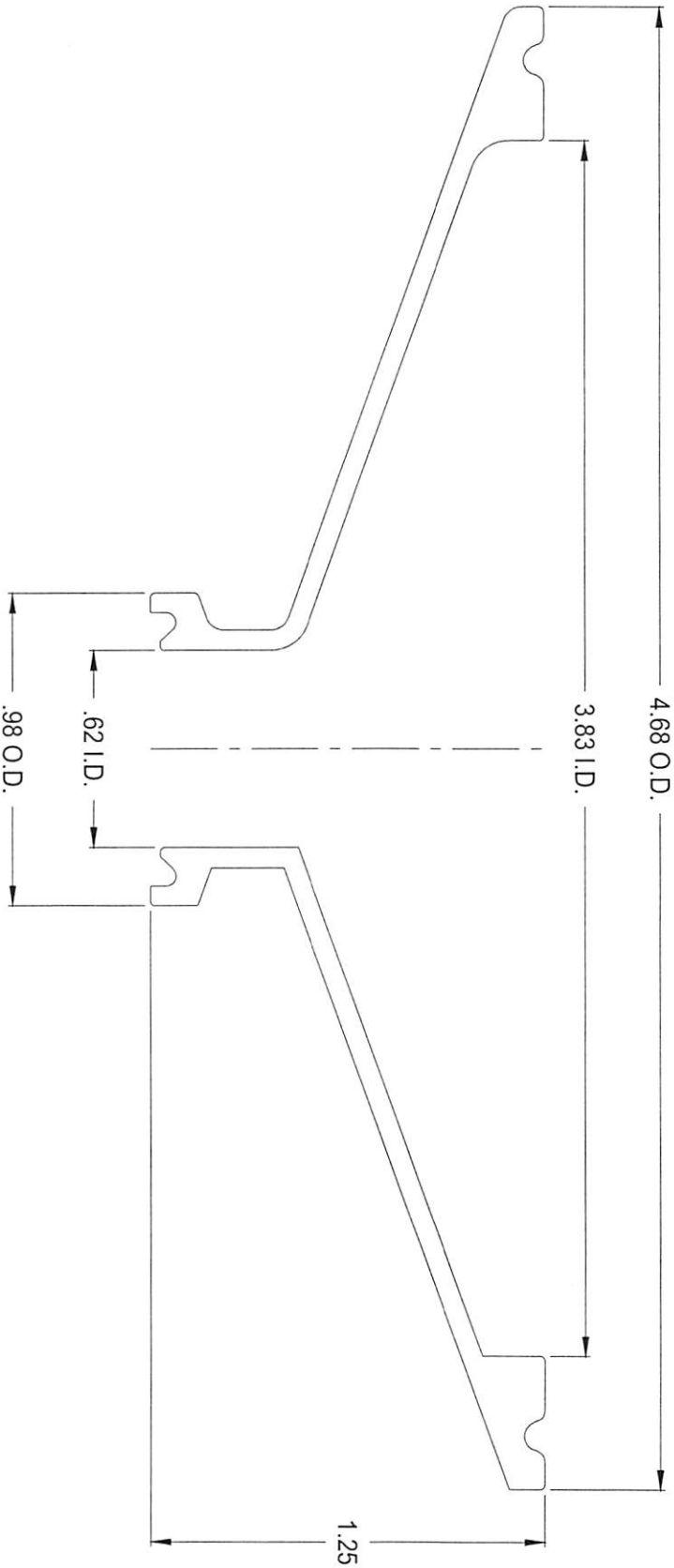

PROPERTY OF ESC. DO NOT DUPLICATE OR DISTRIBUTE.

**EAGLE**  
STAINLESS  
www.eaglestainless.com

816 NINA WAY

WARMINSTER PA 18974

TEL#: 215-957-9333

FAX#: 215-957-9330

Customer and/or Vendor agrees to keep confidential the contents of any documents and materials including but not limited to Quotation(s), Purchase Order(s), and Drawing(s) that Eagle Stainless Container and its agents receive from Customer and/or Vendor and to include section of Eagle Stainless Container and/or Vendor agrees to indemnify Eagle Stainless for all damages (including all attorneys' fees and costs incurred) in connection with any unauthorized use or disclosure of such confidential information by any of Customer and/or Vendor's employees or agents.

DRAWING#: RD4075A-1-02A  
MATERIAL: 1.316L-SS  
CAPACITY: N/A  
FINISH: ELECTROPOLISHED  
MODEL #: 4" X 3/4" TR-CLAMP REDUCER

DRAWN BY: BEN S. KWON  
(1) APPROVED BY: [Signature]  
(3) APPROVED BY: [Signature]

DATE: 01/24/2019

(2) APPROVED BY: [Signature]

DO NOT SCALE.  
APPROVED BY (CUSTOMER SIGNATURE):

TOLERANCES UNLESS OTHERWISE SPECIFIED	
THREE PLACE DECIMAL	+/- .010"
TWO PLACE DECIMAL	+/- .100"
ONE PLACE DECIMAL	+/- .200"
FRACTIONS	+/- 1/32"
ANGULARITY	+/- 1/2 deg.
RADIUS	+/- .132" - .031"