

2" TC x 1/2" TC REDUCER

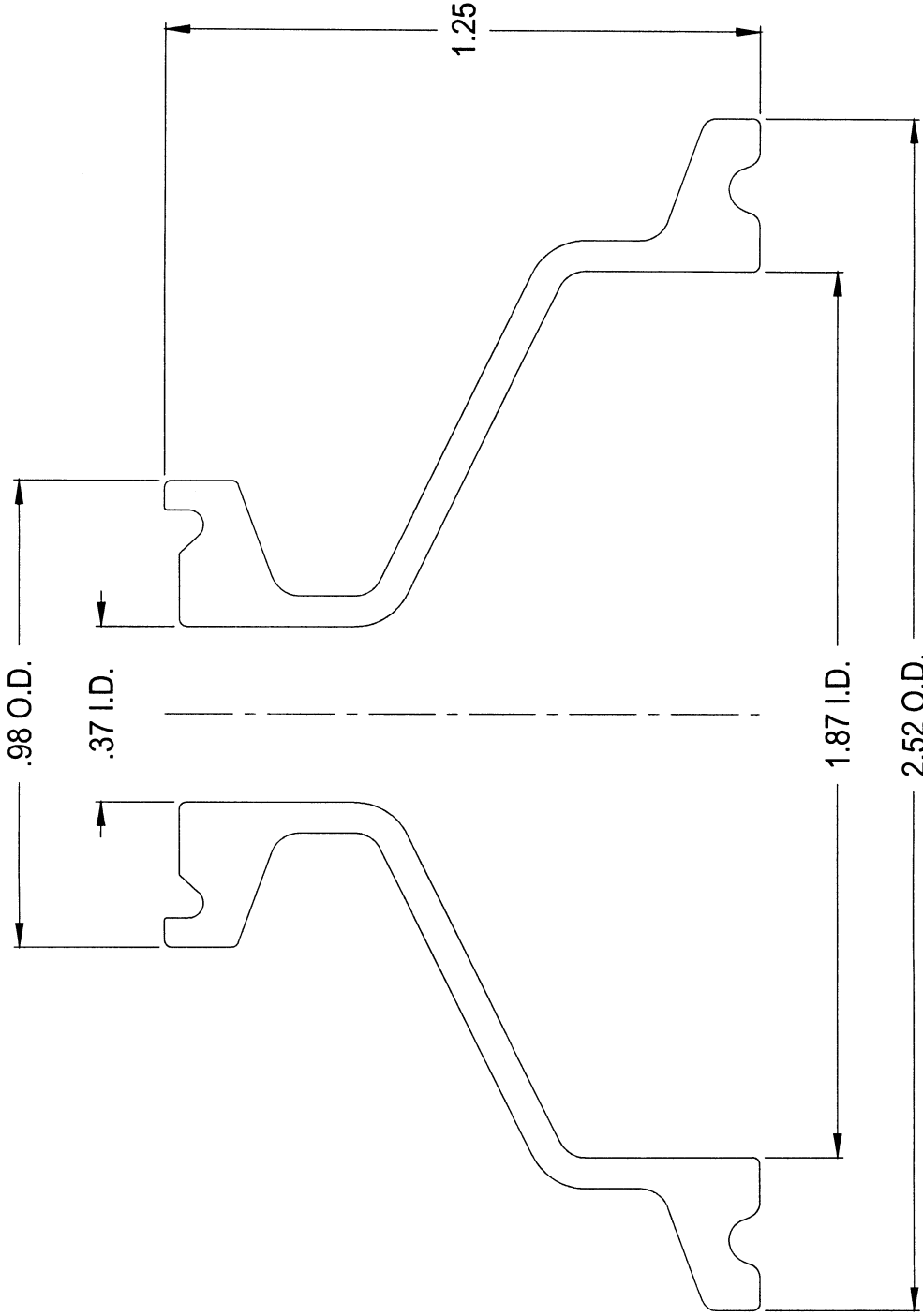

PROPERTY OF ESC. DO NOT DUPLICATE OR DISTRIBUTE.

EAGLE STAINLESS www.eaglestainless.com	816 NINA WAY WARMINSTER PA 18974 TEL#: 215-957-9333 FAX#: 215-957-9330	Customer and/or Vendor agrees to keep confidential the contents of any documents and materials including but not limited to Quotation(s), Invoice(s), Purchase Order(s), and Drawing(s) that Eagle Stainless provides to Customer and/or Vendor and acknowledges that they are trade secrets of Eagle Stainless. Customer and/or Vendor agrees to indemnify Eagle Stainless for all damages (including all attorneys' fees and costs) incurred in connection with any unauthorized use of and/or disclosure of such confidential information by any of Customer and/or Vendor's employees or agents.	DRAWING# : RD2005A-1-02A MATERIAL : T-316L-SS CAPACITY : N/A FINISH : ELECTROPOLISHED MODEL # : 2" x 1/2" TC REDUCER	DRAWN BY : BEN S. KWON DATE : 01/24/2019 (1) APPROVED BY : <i>[Signature]</i> (2) APPROVED BY : <i>[Signature]</i> (3) APPROVED BY : <i>[Signature]</i> ALL DIMENSIONS ARE INCHES. DO NOT SCALE. APPROVED BY (CUSTOMER SIGNATURE):	TOLERANCES UNLESS OTHERWISE SPECIFIED THREE PLACE DECIMAL +/- .010" TWO PLACE DECIMAL +/- .125" ONE PLACE DECIMAL +/- .250" FRACTIONS +/- 1/32" ANGULARITY +/- 1/2 deg. RADIUS +/- 1/32" - .031"
---	---	--	--	---	--