

3" TC x 2" TC REDUCER

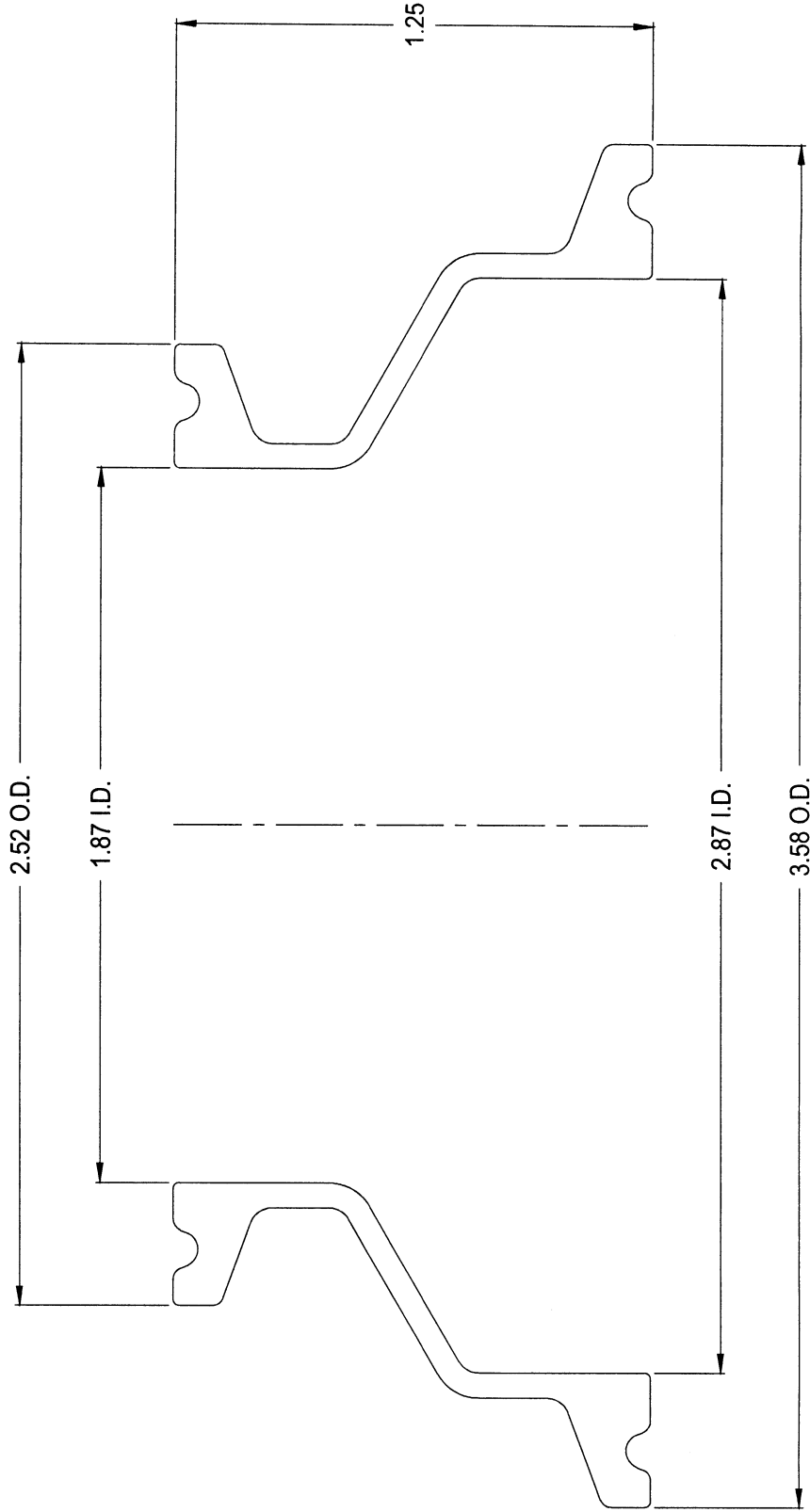

| | | | | | | |
|---|---|---|---|--|--|--|
| EAGLE STAINLESS www.eaglestainless.com | 816 NINA WAY WARMINSTER PA 18974 TEL#: 215-957-9333 FAX#: 215-957-9330 | Customer and/or Vendor agrees to keep confidential the contents of any documents and materials including but not limited to Quotation(s), Invoice(s), Purchase Order(s), and Drawing(s) that Eagle Stainless provides to Customer and/or Vendor, and acknowledges that they are trade secrets of Eagle Stainless. Customer and/or Vendor agrees to keep confidential all information and data of any nature, type, form and cost (if any) in connection with any unsolicited use or disclosure of such confidential information by any of Customer and/or Vendor's employees or agents. | DRAWING# : RD3020A-1-02A MATERIAL : T-316L-SS CAPACITY : N/A FINISH : ELECTROPOLISHED MODEL # : 3" x 2" TRI-CLAMP REDUCER | DRAWN BY : BEN S. KWON DATE : 12/11/2018 (1) APPROVED BY : <i>BK</i> (2) APPROVED BY : <i>AK</i> (3) APPROVED BY : <i>AK</i> ALL DIMENSIONS ARE INCHES. DO NOT SCALE. APPROVED BY (CUSTOMER SIGNATURE): | PROPERTY OF ESC. DO NOT DUPLICATE OR DISTRIBUTE. | |
| | | | | TOLERANCES UNLESS OTHERWISE SPECIFIED THREE PLACE DECIMAL +/- .010" TWO PLACE DECIMAL +/- .100" ONE PLACE DECIMAL +/- .200" FRACTIONS +/- 1/32" ANGULARITY +/- 1/2 Deg. RADIUS +/- .132" - .031" | | |
| | | | | | | |
| | | | | | | |