

1" TC X 1/2" TC REDUCER

CONFIDENTIAL
Property of
Eagle Stainless Container

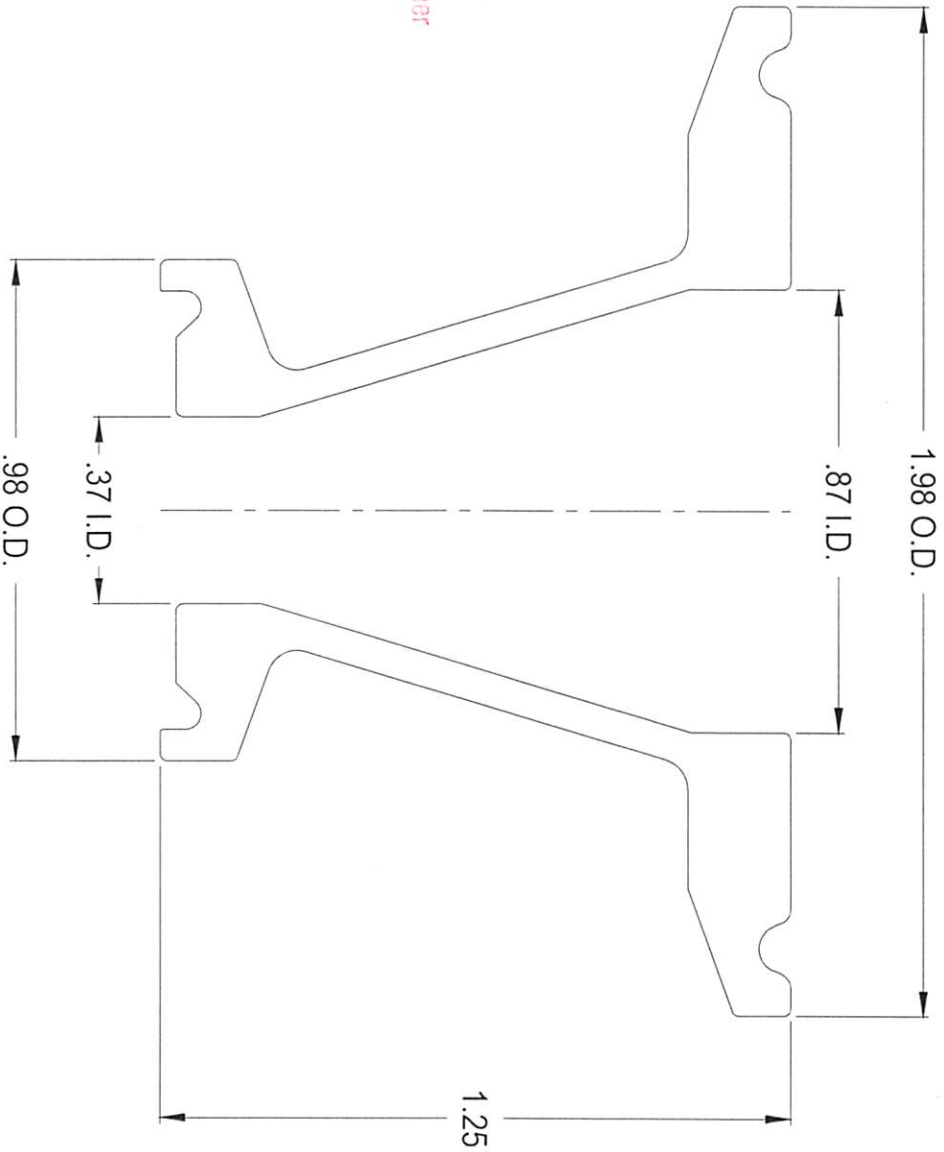

PROPERTY OF ESC. DO NOT DUPLICATE OR DISTRIBUTE.

EAGLE
STAINLESS
www.eaglestainless.com

816 NINA WAY
WARRMINSTER PA 18974
TEL#: 215-957-9333
FAX#: 215-957-9330

Customer and/or Vendor agrees to keep confidential the contents of any documents and materials including but not limited to Quotations/Invoices/ Purchase Orders/ and Drawings/ that Eagle Stainless provides to Customer and/or Vendor and acknowledges that they are trade secrets of Eagle Stainless. Customer and/or Vendor agrees to indemnify Eagle Stainless for all damages (including all attorneys' fees and costs incurred) in connection with any unauthorized use or disclosure of such confidential information by any of Customer and/or Vendor's employees or agents.

DRAWING#: RD1005A-1-02A
MATERIAL : T-316L-SS
CAPACITY : N/A
FINISH : ELECTROPOLISHED
MODEL # : 1" TC X 1/2" TC REDUCER

DRAWN BY : BEN S. KWON
DATE : 11/28/2018
(1) APPROVED BY : *[Signature]*
(2) APPROVED BY : *[Signature]*
(3) APPROVED BY : *[Signature]*
ALL DIMENSIONS ARE INCHES
DO NOT SCALE
APPROVED BY (CUSTOMER SIGNATURE):

TOLERANCES UNLESS OTHERWISE SPECIFIED
THREE PLACE DECIMAL +/-.010"
TWO PLACE DECIMAL +/-.100"
ONE PLACE DECIMAL +/-.200"
FRACTIONS +/-.1/32"
ANGULARITY +/-.1/2 deg.
RADIUS +/-.1/32" - .031"