

3" TC X 1/2" TC REDUCER

CONFIDENTIAL
Property of
Eagle Stainless Container

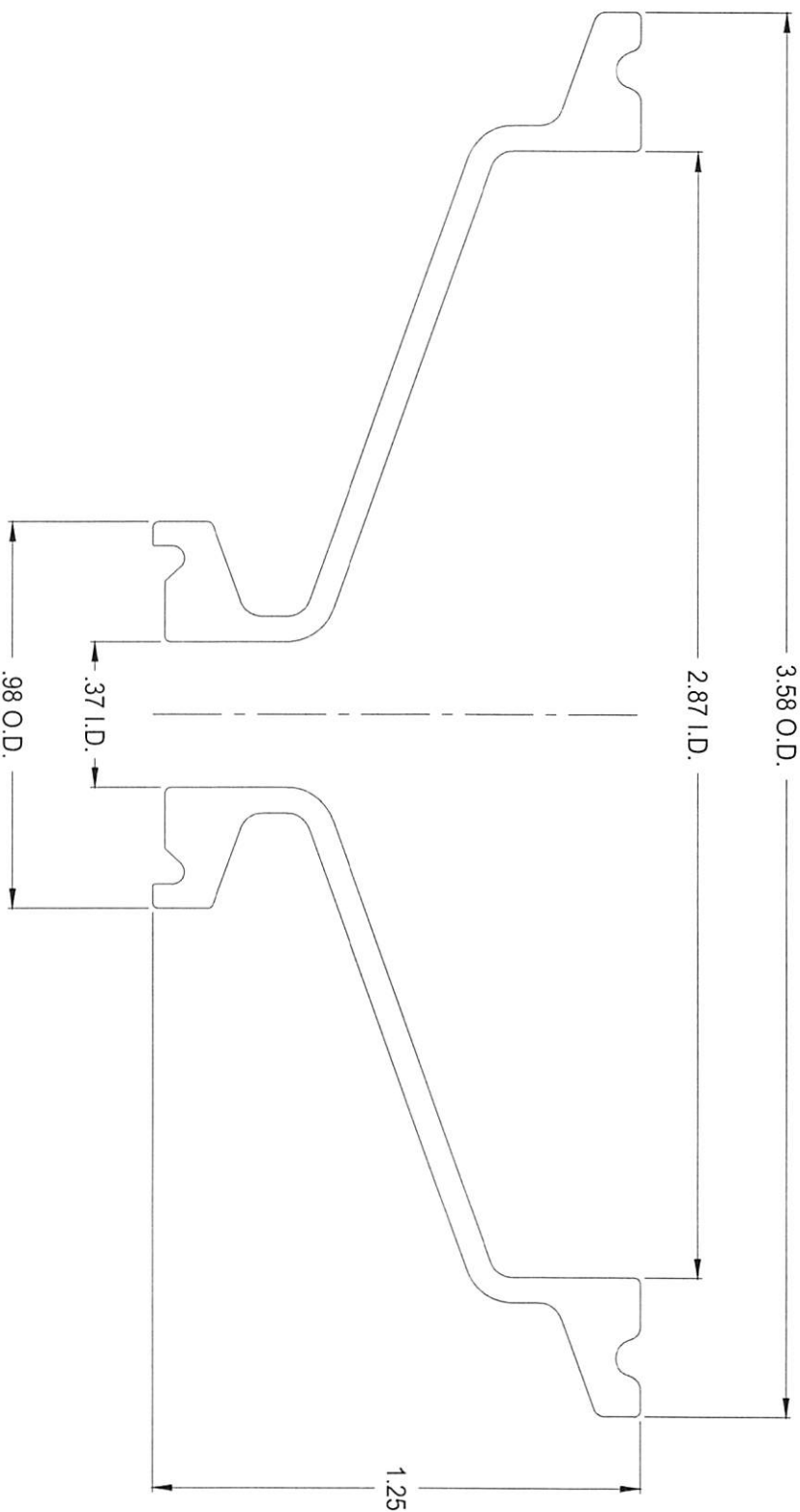

PROPERTY OF ESC. DO NOT DUPLICATE OR DISTRIBUTE.

EAGLE
STAINLESS
www.eaglestainless.com

816 NINA WAY
WARMINSTER PA 18974
TEL#: 215-957-9333
FAX#: 215-957-9330

Customer and/or Vendor agrees to keep confidential the contents of any documents and materials including but not limited to Quotations(s) Invoice(s), Purchase Order(s), and Drawing(s) that Eagle Stainless provides to Customer and/or Vendor and acknowledges that they are trade secrets of Eagle Stainless. Customer and/or Vendor agrees to indemnify Eagle Stainless for all damages (including all attorneys' fees and costs incurred) in connection with any unauthorized use or disclosure of such confidential information by any of Customer and/or Vendor's employees or agents.

DRAWING# : RD3005A-1-02A	DRAWN BY : BEN S. KWON	DATE : 11/28/2018	TOLERANCES UNLESS OTHERWISE SPECIFIED
MATERIAL : T-316L-SS	(1) APPROVED BY :	(2) APPROVED BY :	THREE PLACE DECIMAL
CAPACITY : N/A	(3) APPROVED BY :		TWO PLACE DECIMAL
FINISH : ELECTROPOLISHED	ALL DIMENSIONS ARE INCHES.	DO NOT SCALE.	ONE PLACE DECIMAL
MODEL # : 3" x 1/2" TRI-CLAMP REDUCER	APPROVED BY (CUSTOMER SIGNATURE) :		FRACTIONS
			ANGULARITY
			RADIUS
			+/- .010"
			+/- .100"
			+/- .200"
			+/- .132"
			+/- .12 deg
			+/- .132" - .031"