

3" TC X 3/4" TC REDUCER

CONFIDENTIAL
Property of
Eagle Stainless Container

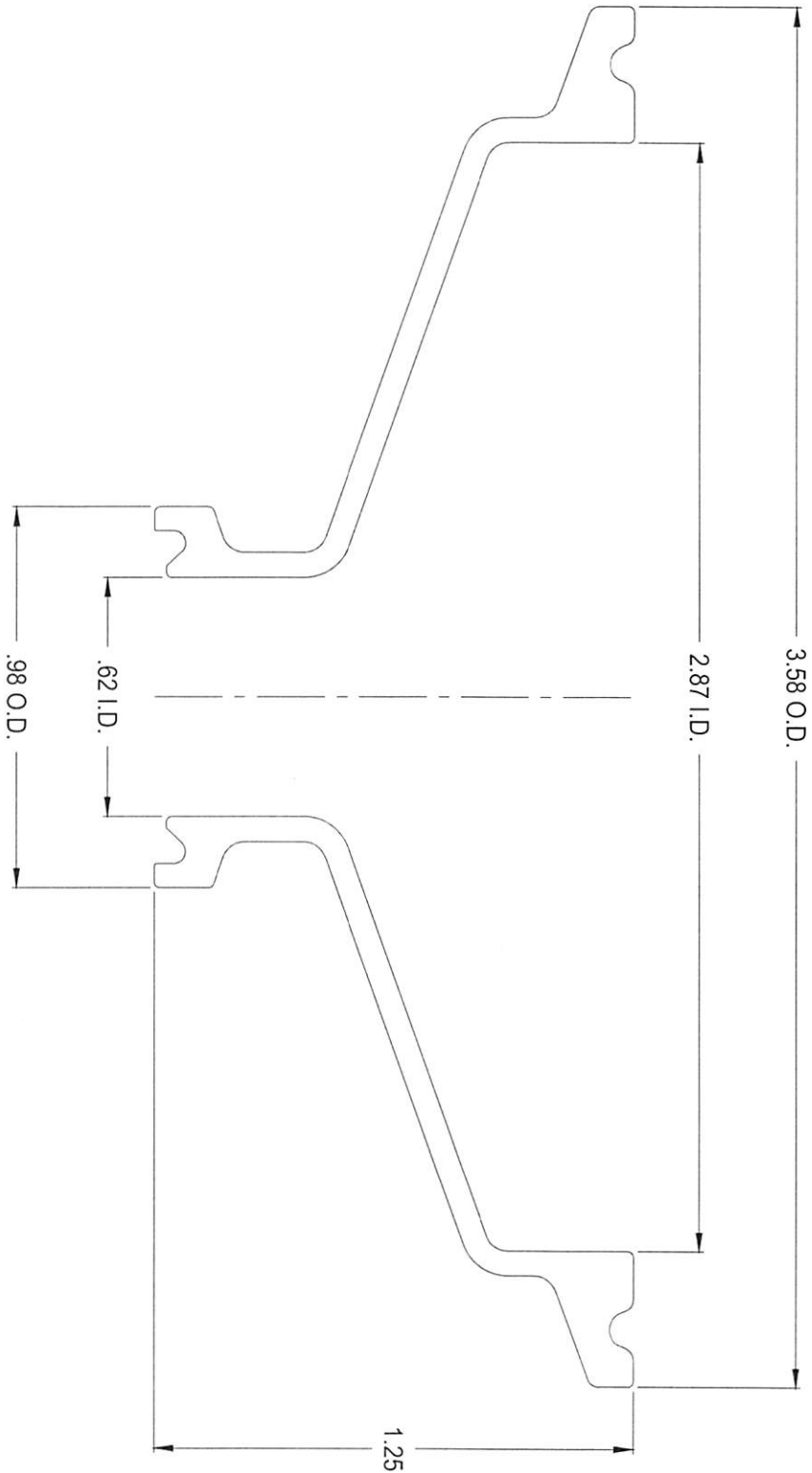

PROPERTY OF ESC. DO NOT DUPLICATE OR DISTRIBUTE

EAGLE STAINLESS www.eaglestainless.com		816 NINA WAY WARMINSTER PA 18974 TEL#: 215-957-9333 FAX#: 215-957-9330		Customer and/or Vendor agrees to keep confidential the contents of any documents and materials including but not limited to Quotation(s) Invoice(s), Purchase Order(s), and Drawing(s) that Eagle Stainless provides to Customer and/or Vendor and acknowledges that they are trade secrets of Eagle Stainless. Customer and/or Vendor agrees to indemnify Eagle Stainless for all damages (including all attorneys' fees and costs incurred) in connection with any unauthorized use or disclosure of such confidential information by any of Customer and/or Vendor's employees or agents.	
DRAWING# :	RD3075A-1-02A	DRAWN BY :	BEN S. KWON	DATE :	11/28/2018
MATERIAL :	T-316L SS	(1) APPROVED BY :	<i>[Signature]</i>	(2) APPROVED BY :	<i>[Signature]</i>
CAPACITY :	N/A	(3) APPROVED BY :	<i>[Signature]</i>	DO NOT SCALE.	
FINISH :	ELECTROPOLISHED	ALL DIMENSIONS ARE INCHES.			
MODEL # :	3" x 3/4" TRI-CLAMP REDUCER	APPROVED BY (CUSTOMER SIGNATURE):			
TOLERANCES UNLESS OTHERWISE SPECIFIED					
THREE PLACE DECIMAL		+/- .010"			
TWO PLACE DECIMAL		+/- .100"			
ONE PLACE DECIMAL		+/- .200"			
FRACTIONS		+/- .1/32"			
ANGULARITY		+/- .1/2 deg			
RADIUS		+/- .1/32" -.031"			