

4" TC X 1/2" TC REDUCER

CONFIDENTIAL
Property of
Eagle Stainless Container

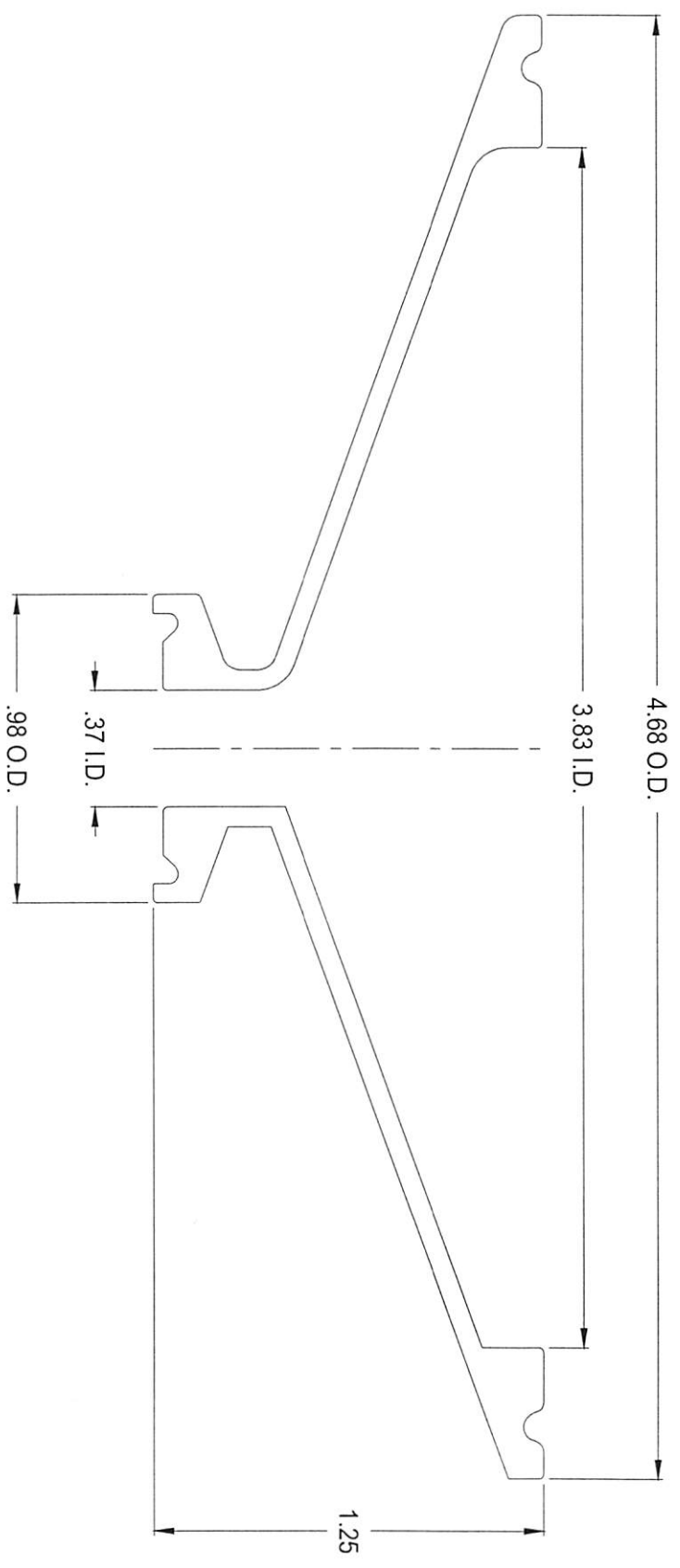

PROPERTY OF ESC. DO NOT DUPLICATE OR DISTRIBUTE

EAGLE
STAINLESS
www.eaglestainless.com

816 NINA WAY
WARMINSTER PA 18974
TEL#: 215-957-9333
FAX#: 215-957-9330

Customer and/or Vendor agrees to keep confidential the contents of any documents and materials including but not limited to Quotation(s), Invoice(s), Purchase Order(s), and Drawing(s) that Eagle Stainless provides to Customer and/or Vendor and acknowledges that they are not to be used for any other purpose without the prior written approval of Eagle Stainless for all details of including all terms, fees and costs (incurred) in connection with any unauthorized use or disclosure of such confidential information by any of Customer and/or Vendor's employees or agents.

DRAWING#: RD4005A-1-02A
MATERIAL: T-316L-SS
CAPACITY: N/A
FINISH: ELECTROPOLISHED
MODEL #: 4" x 1/2" TR-CLAMP REDUCER

DRAWN BY: BEN S. KWON
DATE: 01/24/2019
(1) APPROVED BY: [Signature]
(2) APPROVED BY: [Signature]
ALL DIMENSIONS ARE INCHES. DO NOT SCALE.
APPROVED BY (CUSTOMER SIGNATURE):

TOLERANCES UNLESS OTHERWISE SPECIFIED	
THREE PLACE DECIMAL	+/- .010"
TWO PLACE DECIMAL	+/- .100"
ONE PLACE DECIMAL	+/- .200"
FRACTIONS	+/- 1/32"
ANGULARITY	+/- 1/2 deg.
RADIUS	+/- .132" - .031"