

3" TC x 1-1/2" TC REDUCER

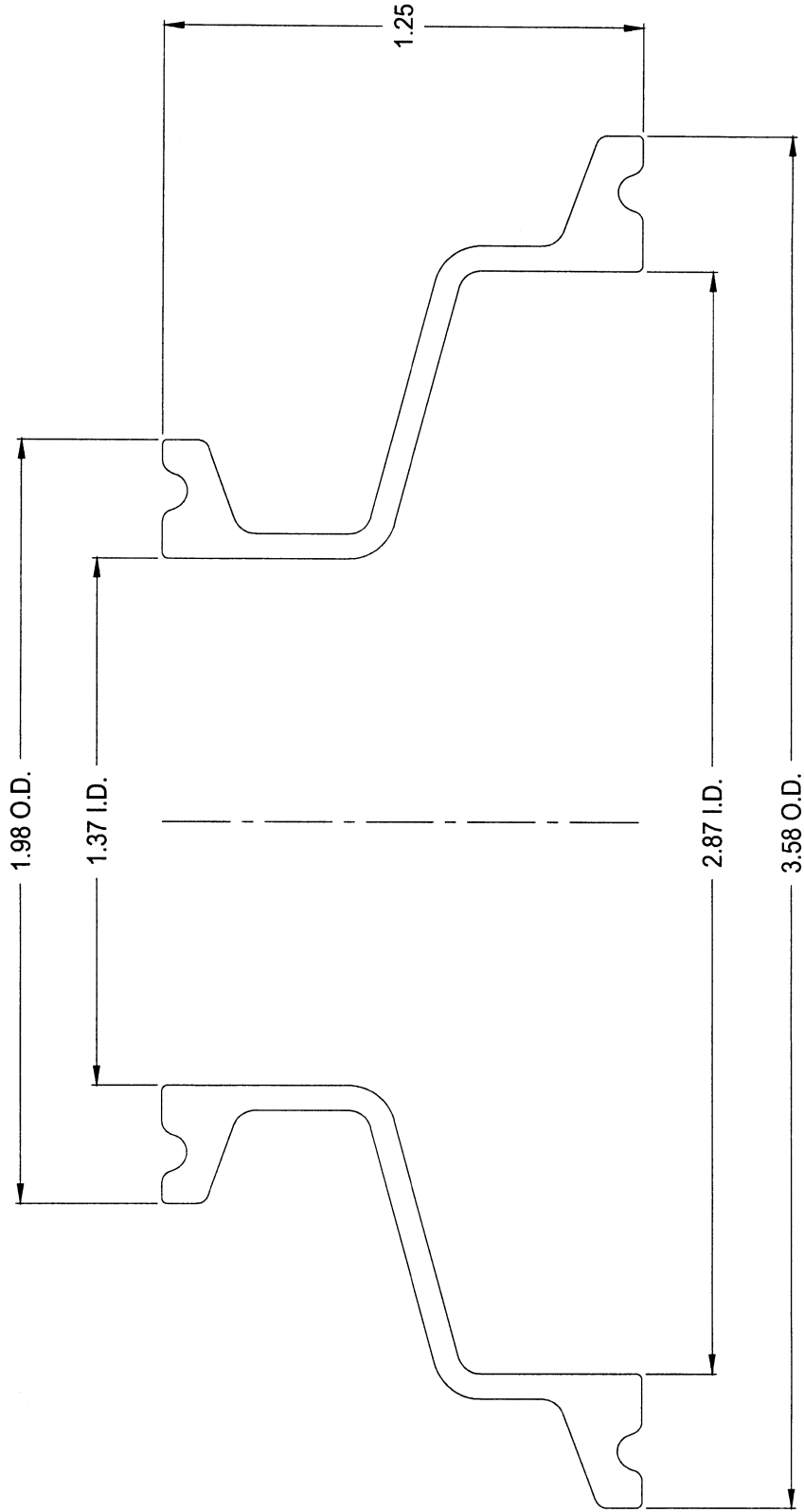

Customer and/or Vendor agrees to keep confidential the contents of any documents and materials including but not limited to Quotation(s), Invoice(s), Purchase Order(s), and Drawing(s) that Eagle Stainless provides to Customer and/or Vendor and acknowledges that they are trade secrets of Eagle Stainless. Customer and/or Vendor agrees to indemnify Eagle Stainless for all damages (including an attorney's fees and costs) in connection with any unauthorized use of or disclosure of such confidential information by any of Customer and/or Vendor's employees or agents.		DRAWING# : RD3015A-1-02A	DRAWN BY : BEN S. KWON	DATE : 12/11/2018	PROPERTY OF ESC. DO NOT DUPLICATE OR DISTRIBUTE.
		MATERIAL : T-316L-SS	(1) APPROVED BY : <i>[Signature]</i>	TOLERANCES UNLESS OTHERWISE SPECIFIED	
		CAPACITY : N/A	(3) APPROVED BY :	THREE PLACE DECIMAL +/- .010"	
		FINISH : ELECTROPOLISHED	ALL DIMENSIONS ARE INCHES. DO NOT SCALE.	TWO PLACE DECIMAL +/- .100"	
		MODEL # : 3" x 1-1/2" TRI-CLAMP REDUCER	APPROVED BY (CUSTOMER SIGNATURE):	ONE PLACE DECIMAL +/- .200"	
				FRACTIONS +/- 1/32"	
				ANGULARITY +/- 1/2 DEG.	
				RADIUS +/- .132" - .031"	

EAGLE
 816 NINA WAY
 WARMINSTER PA 18974
 TEL# : 215-957-9333
 STAINLESS
 www.eaglestainless.com