

FRONT VIEW

* ASME PRESSURE VESSEL

MATERIAL : TYPE 316L STAINLESS STEEL
 PLATE PER A.S.M.E. SPEC. SA-240
 TUBE PER A.S.M.E. SPEC. SA-249

CONFIDENTIAL
 Property of
 Eagle Stainless Container

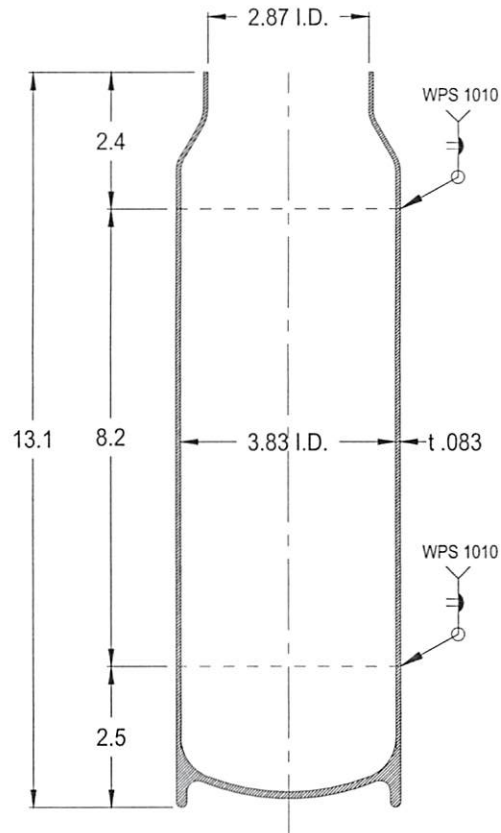

A-A SECTION VIEW

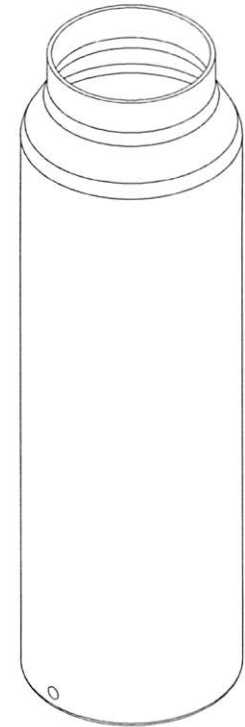

NOTES :

1. CONSTRUCTION MEETS LATEST A.S.M.E. "SEC. VIII DIV. 1" 2021 EDITION
2. ALL WELDS TO BE GTAW - WPS 1010 REV. 0
3. MAXIMUM WORKING PRESSURE : 195 psi @ 125° F
4. HYDROSTATIC TEST : 300 psi @ ROOM TEMP.
5. INSIDE SURFACE FINISH : 12 Ra or BETTER Micro-inch INCL. (Electropolished optional)
 WELDS ARE GROUND SMOOTH & FLUSH
 TOP GIRTH SEAM WILL BE POLISHED.
6. HELIUM LEAK TEST HELIUM LEAK RATE : 1×10^6 mbar L/SEC. or BETTER (optional)

PROPERTY OF ESC. DO NOT DUPLICATE OR DISTRIBUTE.

EAGLE STAINLESS
 816 NINA WAY
 WARMINSTER PA 18974
 TEL# : 215-957-9333
 FAX# : 215-957-9330
 www.eaglestainless.com

Customer and/or Vendor agrees to keep confidential the contents of any documents and materials including but not limited to Quotation(s), Invoice(s), Purchase Order(s), and Drawing(s) that Eagle Stainless provides to Customer and/or Vendor and acknowledges that they are trade secrets of Eagle Stainless. Customer and/or Vendor agrees to indemnify Eagle Stainless for all damages (including all attorneys' fees and costs incurred) in connection with any unauthorized use or disclosure of such confidential information by any of Customer and/or Vendor's employees or agents.

| | | |
|--|--------------------------------------|--------------------------------------|
| DRAWING# : EPV2E-E21-1-01A | DRAWN BY : BEN S. KWON | DATE : 02/01/2022 |
| MATERIAL : See Note on Drawing for Detail. | (1) APPROVED BY : <i>[Signature]</i> | (2) APPROVED BY : <i>[Signature]</i> |
| CAPACITY : 2.0 L | NOTE : ALL DIMENSIONS ARE INCHES. | |
| FINISH : See Note on Drawing for Detail. | DO NOT SCALE. | |
| JOB # : EPV2E-E21 | APPROVED BY (CUSTOMER SIGNATURE) : | |

| |
|---------------------------------------|
| TOLERANCES UNLESS OTHERWISE SPECIFIED |
| THREE PLACE DECIMAL +/- .010" |
| TWO PLACE DECIMAL +/- .100" |
| ONE PLACE DECIMAL +/- .200" |
| FRACTIONS +/- 1/32" |
| ANGULARITY +/- 1/2 deg. |

CONFIDENTIAL
Property of
Eagle Stainless Container

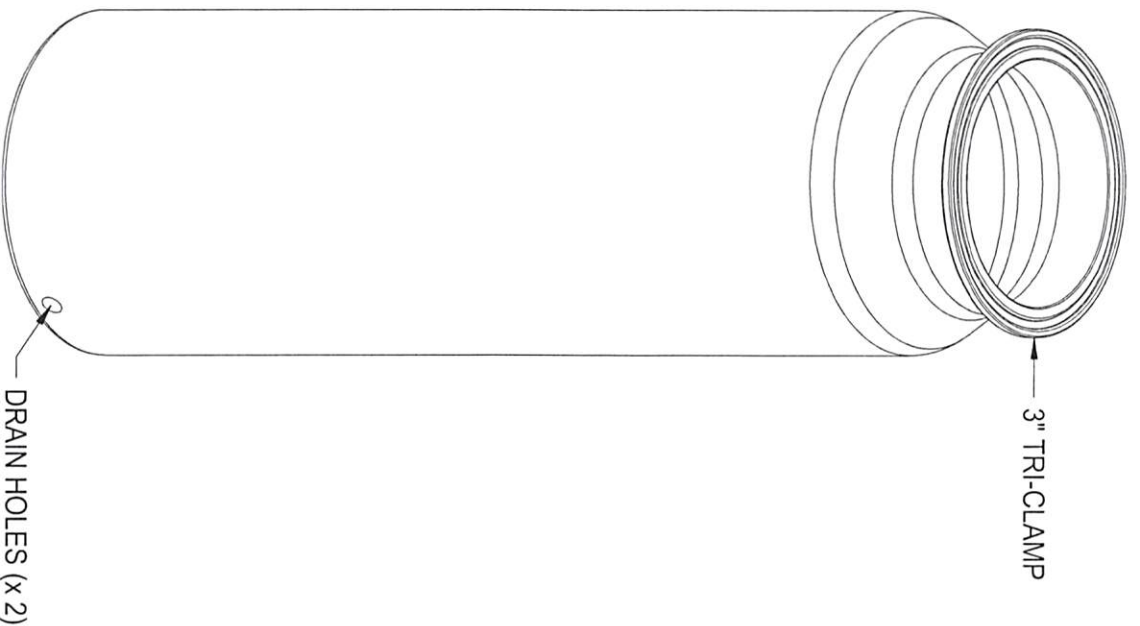
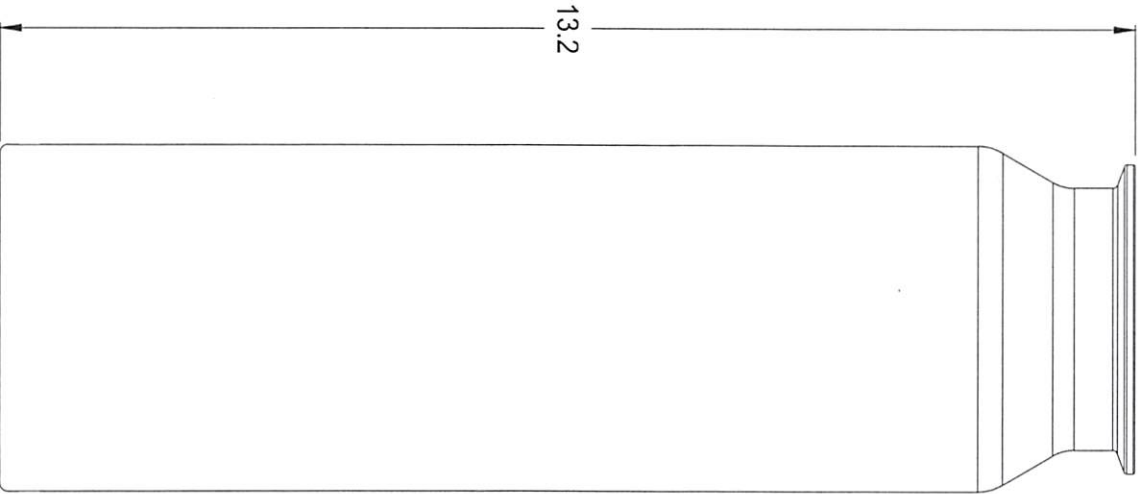

PROPERTY OF ESC. DO NOT DUPLICATE OR DISTRIBUTE.

EAGLE
STAINLESS
www.eaglestainless.com

816 NINA WAY
WARMINSTER PA 18974
TEL# : 215-957-9333
FAX# : 215-957-9330

Customer and/or Vendor agrees to keep confidential the contents of any documents and materials including but not limited to Quotation(s), Invoice(s), Purchase Order(s), and Drawing(s) that Eagle Stainless provides to Customer and/or Vendor and acknowledges that they are trade secrets of Eagle Stainless. Customer and/or Vendor agrees to indemnify Eagle Stainless for all damages (including all attorneys' fees and costs incurred) in connection with any unauthorized use or disclosure of such confidential information by any of Customer and/or Vendor's employees or agents.

| | | | |
|---|--------------------------------------|--------------------------------------|---------------------------------------|
| DRAWING# : EPVZE-E21-1-01B | DRAWN BY : BEN S. KWON | DATE : 02/01/2022 | TOLERANCES UNLESS OTHERWISE SPECIFIED |
| MATERIAL : 1.316L-SS | (1) APPROVED BY : <i>[Signature]</i> | (2) APPROVED BY : <i>[Signature]</i> | THREE PLACE DECIMAL |
| CAPACITY : 20 L | NOTE : ALL DIMENSIONS ARE INCHES. | DO NOT SCALE. | TWO PLACE DECIMAL |
| FINISH : See Drawing# EPVZE-E21-1-01A for Detail. | APPROVED BY (CUSTOMER SIGNATURE) : | | ONE PLACE DECIMAL |
| JOB# : EPVZE-E21 | | | FRACTIONS |
| | | | ANGULARITY |
| | | | +/- .010" |
| | | | +/- .100" |
| | | | +/- .200" |
| | | | +/- .132" |
| | | | +/- .1/2 deg |